

TONGA® THERM A



Tonga® Therm A ceiling offers an excellent sound absorption, resistance to bending and thermal resistance, making it ideal for open-space.



Tonga® Therm A



PANEL DESCRIPTION

| | |
|----|---|
| 1: | Decorative glass fiber veil in white or EuroColor |
| 2: | High density stone wool panel, 77 mm thick |
| 3: | A edges |
| 4: | Natural glass veil on reverse side |

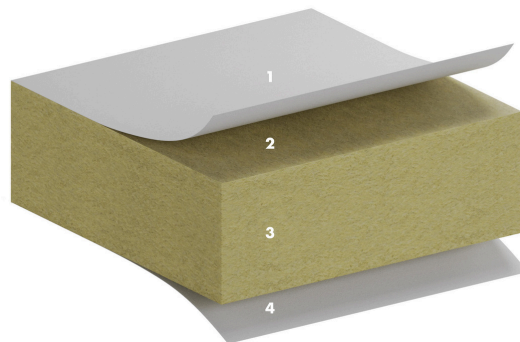

TYPE OF APPLICATION

- Additional areas
- Education
- Office
- Healthcare



ACOUSTICS

Sound Absorption

Test results according to EN ISO 354. Classification according to EN ISO 11654.

α_p , Practical sound absorption coefficient

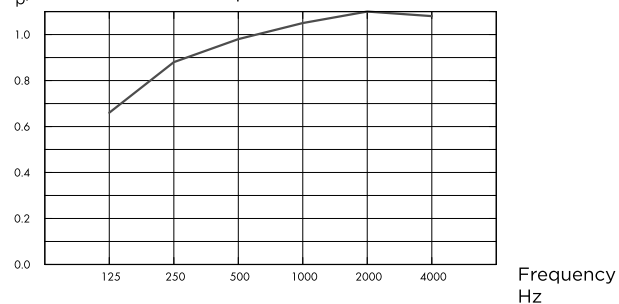

— Eurocoustic Tonga® Therm A, 200 mm o.d.s.
o.d.s = overall depth of system

| THK mm | o.d.s. mm | α_p , Practical sound absorption coefficient | | | | | | α_w | Sound absorption class |
|--------|-----------|---|--------|--------|---------|---------|---------|------------|------------------------|
| | | 125 Hz | 250 Hz | 500 Hz | 1000 Hz | 2000 Hz | 4000 Hz | | |
| 77 | 200 | 0.66 | 0.88 | 0.98 | 1.05 | 1.10 | 1.08 | 1.00 | A |



VISUAL APPEARANCE

| Property | White 09 |
|--------------------------|----------|
| Light Reflectance (LRV%) | 87% |
| Whiteness (L*) | 94% |
| Gloss (85°) | 1.2 |



FIRE REACTION

| Standard | White 09, EuroColors, EuroDesign | Silver M5 |
|------------|----------------------------------|--------------------|
| EN 13501-1 | Euroclass A1 | Euroclass A2-s1,d0 |



HUMIDITY RESISTANCE

100% flat irrespective of the Relative Humidity.



INDOOR AIR QUALITY

| Certificate / Label | |
|---------------------|--------------------------|
| French VOC | A+ |
| Eurofins | Indoor Air Comfort® Gold |



MATERIAL HEALTH

| | |
|--|--|
| C2C Certified Material Health Certificate™ | This product has received a C2C Certified Material Health Certificate™ at the Bronze level (standard version 4.0). The C2C Certified Material Health Certificate™ is a verification of the health and safety of a product's composition using the Material Health requirements of the Cradle-to-Cradle Certified Product Standard. |
| EUCEB | Eurocoustic panels are manufactured using mineral wool certified by the European Certification Board for mineral wool products (EUCEB), which independently confirms that mineral wool is produced in conformity with the Note Q of European Regulation (EC) No 1272/2008 and therefore classification as a carcinogen does not apply. |
| REACH | Eurocoustic products comply with the REACH regulation of the European Chemicals Agency and therefore do not contain any Substances of Very High Concern (SVHC) with potential negative impacts on human health or the environment above 100ppm. |



CARBON FOOTPRINT

Life cycle stages A1 to C4 of the EPD, in compliance with ISO 14025 / EN 15804.

| | kg CO ₂ equiv/m ² |
|---------------|---|
| Tonga Therm A | 8.69 |



CIRCULARITY

| | |
|--------------------------|------------------|
| Minimum recycled content | 26% |
| Recyclability | Fully recyclable |



CRADLE TO CRADLE CERTIFIED®

This product is Cradle to Cradle Certified® at Bronze level (version 4.0).



CLEANABILITY

The ceiling surface does not retain dust, which makes the panels easier to clean. The ceiling can be cleaned using a light brush or a vacuum cleaner. This type of cleaning will help extend the service life of the ceilings.



INSTALLATION

- You are advised to ensure that air can circulate between the rooms and the plenum to balance the temperature and pressures on each side of the ceiling.
- Tiles can be cut with a craft knife without generating any noise or dust.
- The direction in which the panels should be installed is indicated on the back of the panels.
- Contact us if any mineral wool is to be laid in the plenum.



THERMAL PROPERTIES

Thermal resistance R = 2.20 m²·K/W (EN 13162).



MECHANICAL PROPERTIES

According to EN 13964 - Annex F, Tonga® Therm A 80 ceilings are classified as C/130N/m² for dimensions 600 x 600 and 1200 x 600. This value should be kept in mind if any mineral wool is to be laid in the plenum.



CE

Eurocoustic ceilings are CE marked according to the European harmonized standard EN13964:2014. CE marked construction products are covered by a Declaration of Performance (DOP) which enables customers and users to easily compare performance of products available on the European market.



PRODUCT RANGE

Tonga® Therm A ceiling packs are shrink-wrapped for protection. Pallets are wrapped in plastic film and must be stored under cover .

| Format | 600x600 | 1200x600 |
|----------------------|-----------|-----------|
| Edge | A | A |
| White O9 | • | • |
| EuroColors | • | • |
| Grids | T24 - T35 | T24 - T35 |
| Panels/pack | 12 | 6 |
| m ² /pack | 4.32 | 4.32 |
| Packs/pallet | 10 | 10 |
| Service class | A | A |

COLOURS AND DESIGN

Colors

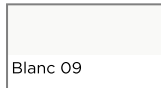

EuroColors

